

HANSON HALL

FIRST FLOOR

#DukesLiveClose
#DukesLiveSupported
#DukesLIVEON

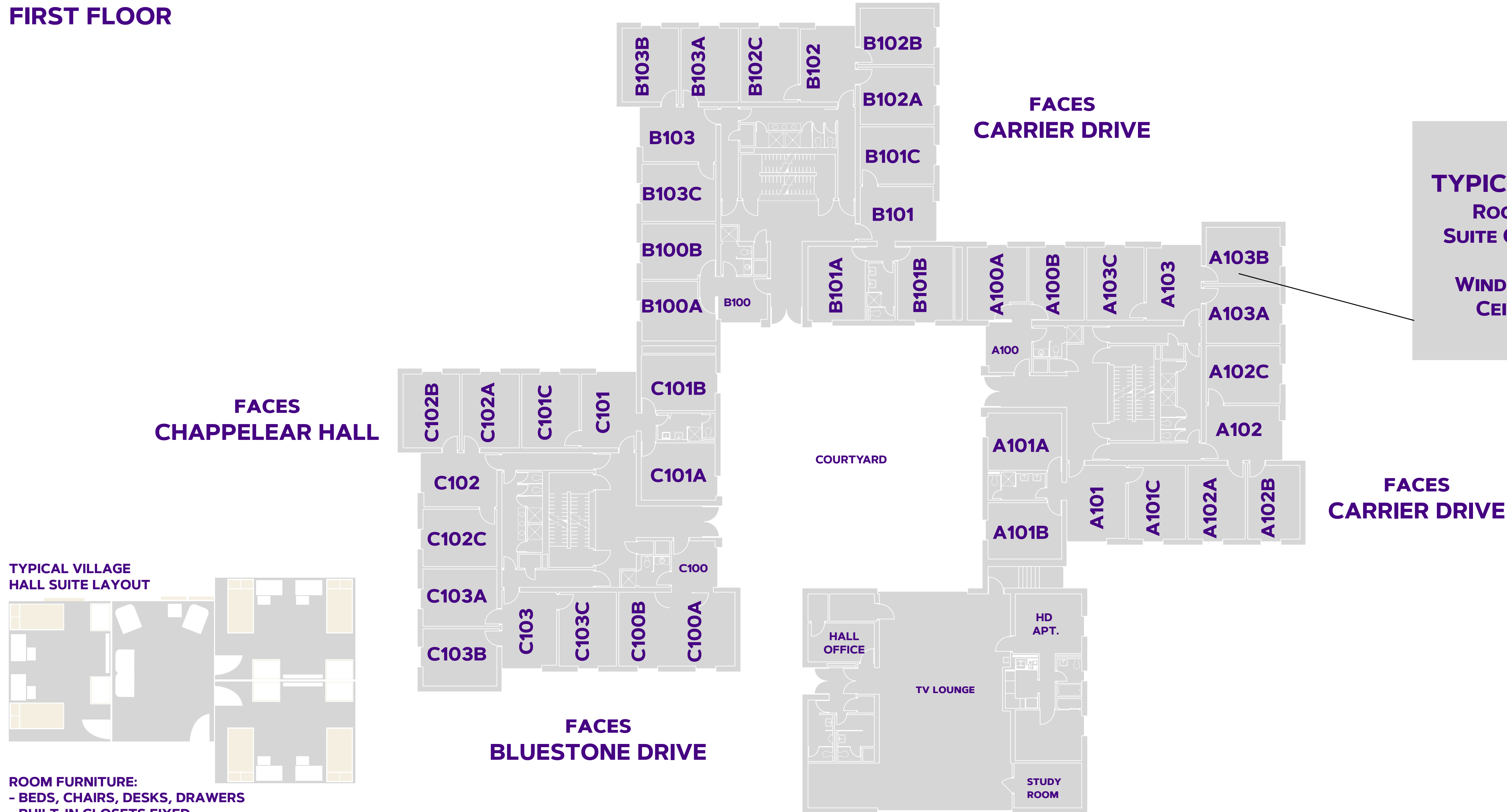

TYPICAL SUITE SPECS
 ROOM SIZE: 9'4" x 14'
 SUITE COMMON AREA SIZE:
 14'6" x 10'10"
 WINDOW SIZE: 3'11" x 5'5"
 CEILING HEIGHT: 7'11"

TYPICAL VILLAGE HALL SUITE LAYOUT

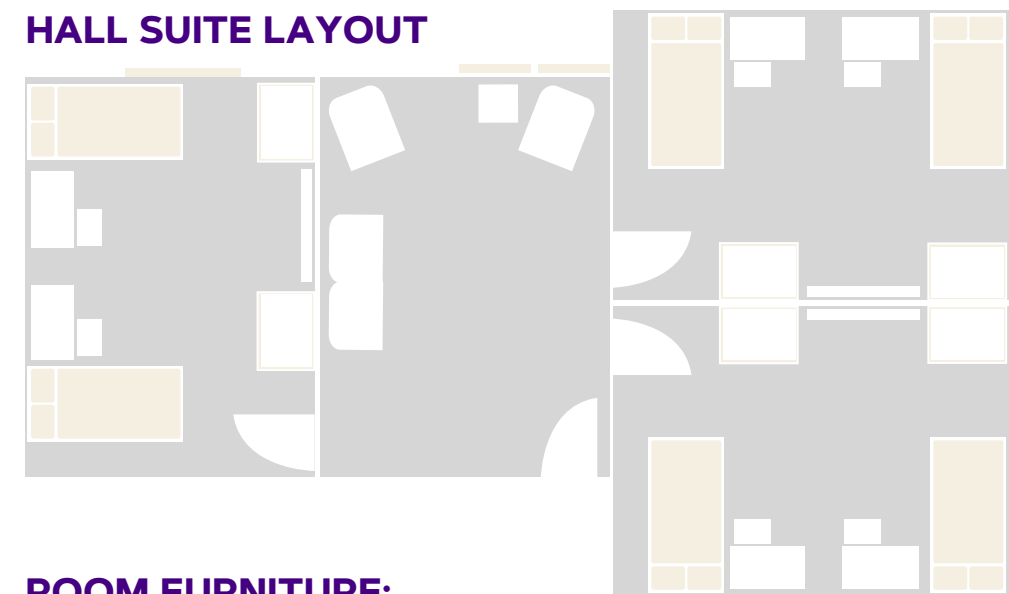

- ROOM FURNITURE:**
- BEDS, CHAIRS, DESKS, DRAWERS
 - BUILT-IN CLOSETS FIXED

- SUITE FURNITURE:**
- SMALL SOFA, END TABLE, & TWO CHAIRS

FOR MORE INFORMATION ON HALLS VISIT:
WWW.JMU.EDU/ORL/OUR-RESIDENCE-HALLS/INDEX.SHTML



HANSON HALL

SECOND FLOOR

#DukesLiveClose
 #DukesLiveSupported
 #DukesLIVEON

FACES
 CHAPPELEAR HALL

FACES
 CARRIER DRIVE

FACES
 CARRIER DRIVE

FACES
 BLUESTONE DRIVE

COURTYARD

TYPICAL SUITE SPECS
 ROOM SIZE: 9'4" x 14'
 SUITE COMMON AREA SIZE:
 14'6" x 10'10"
 WINDOW SIZE: 3'11" x 5'5"
 CEILING HEIGHT: 7'11"

TYPICAL VILLAGE
 HALL SUITE LAYOUT

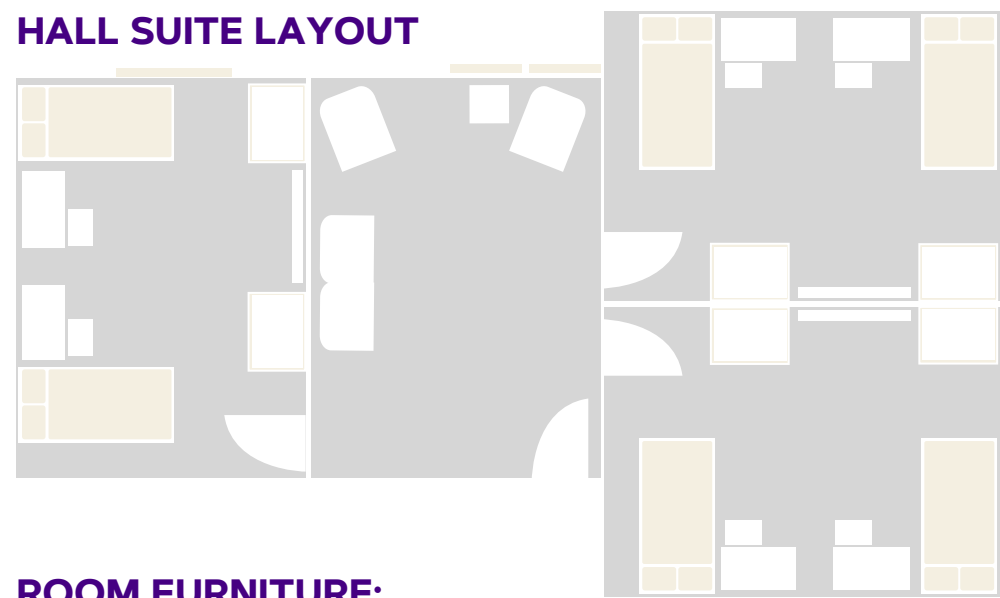

- ROOM FURNITURE:**
- BEDS, CHAIRS, DESKS, DRAWERS
 - BUILT-IN CLOSETS FIXED

- SUITE FURNITURE:**
- SMALL SOFA, END TABLE, & TWO CHAIRS

FOR MORE INFORMATION ON HALLS VISIT:
WWW.JMU.EDU/ORL/OUR-RESIDENCE-HALLS/INDEX.SHTML



Residence Life

HANSON HALL

THIRD FLOOR

#DukesLiveClose
 #DukesLiveSupported
 #DukesLIVEON

FACES
 CHAPPELEAR HALL

FACES
 CARRIER DRIVE

FACES
 CARRIER DRIVE

FACES
 BLUESTONE DRIVE

COURTYARD

TYPICAL SUITE SPECS
 ROOM SIZE: 9'4" x 14'
 SUITE COMMON AREA SIZE:
 14'6" x 10'10"
 WINDOW SIZE: 3'11" x 5'5"
 CEILING HEIGHT: 7'11"

TYPICAL VILLAGE
 HALL SUITE LAYOUT

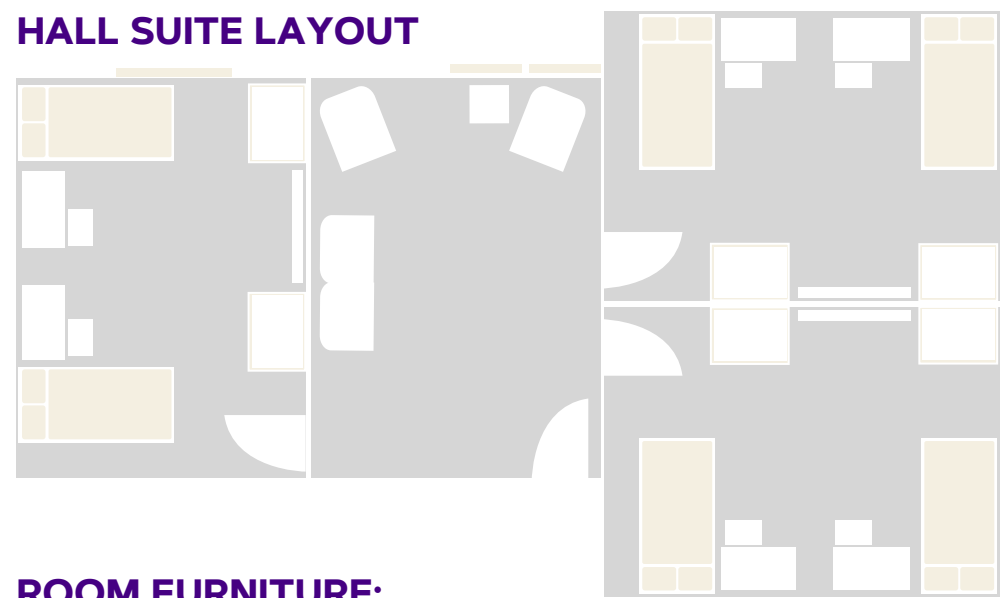

- ROOM FURNITURE:**
- BEDS, CHAIRS, DESKS, DRAWERS
 - BUILT-IN CLOSETS FIXED

- SUITE FURNITURE:**
- SMALL SOFA, END TABLE, & TWO CHAIRS

FOR MORE INFORMATION ON HALLS VISIT:
WWW.JMU.EDU/ORL/OUR-RESIDENCE-HALLS/INDEX.SHTML



Residence Life